

Water Pump Pliers

- Induction hardened jaw toothing, extremely hard and durable
- With heavy duty box joint construction
- Self-gripping on pipes and nuts
- 7-position adjustment
- Optimum lever action
- Safety clamping protection against squeezing injuries
- Chrome Vanadium electric steel, oil-hardened

Article No.	Length (in.)	Handles	Pipe Capacities (in)
HO-250-01	10	Dip-Coated	1/8~1-1/2

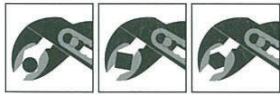

HO-250



Adjustable Wrenches

Article No.	Length(in.)	Pipe Capacities (mm)
HAW-100	4	13
HAW-150	6	20
HAW-200	8	25
HAW-250	10	30
HAW-300	12	35
HAW-375	15	45
HAW-450	18	55
HAW-600	24	65

- Extra capacity allows use of a smaller size wrench to handle bigger jobs, especially in confined spaces.
- Forged heat-treated alloy steel for maximum strength and light weight.
- With a rust resistant high polish chrome finish.
- Precision-machined jaws are individually chosen and assembled by hand for smooth operation.
- Handle hole for tethering, hanging or storage.

HAW-100

